



# FHP and VP SHEAVES

Fractional Horsepower and Variable Pitch Sheaves

*Martin*

SPROCKET & GEAR, INC.

[www.martinsprocket.com](http://www.martinsprocket.com)

# AK Single Groove FHP Sheaves Bored-To-Size

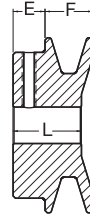

**TYPE A**  
Solid

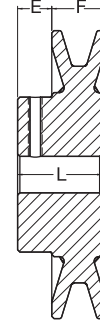

**TYPE B**  
Web

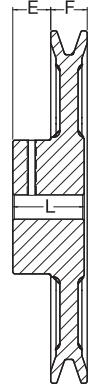

**TYPE C**  
Arm / Spoke

## Dimensions in inches

Part Number	Diameter			Type	Stock Finished Bores Includes Keyway and Setscrew	F	E	L Thru Bore	Weight Lbs. (Approx.)
	OD	Datum A(4L) Belts	Pitch 3L Belts						
AK15	1.55	1.30	-	A	1/2 - 5/8	21/32	7/16	13/32	0.3
AK17	1.75	1.50	1.16	A	1/2 - 5/8	21/32	7/16	15/16	0.3
AK19	1.95	1.70	1.36	A	1/2 - 5/8 - 3/4 - 7/8	21/32	7/16	15/16	0.5
AK20	2.00	1.80	1.46	A	1/2 - 5/8 - 3/4 -	21/32	7/16	15/16	0.5
AK21	2.10	1.90	1.56	A	1/2 - 5/8 - 3/4 -	21/32	7/16	15/16	0.5
AK22	2.20	2.00	1.66	A	1/2 - 5/8 - 3/4 - 7/8	21/32	7/16	15/16	0.6
AK23	2.30	2.10	1.76	A	1/2 - 5/8 - 3/4 -	21/32	7/16	15/16	0.6
AK24	2.40	2.20	1.86	A	1/2 - 5/8 - 3/4 - 7/8 - - 1	21/32	7/16	15/16	0.6
AK25	2.50	2.30	1.96	B	1/2 - 5/8 - 3/4 - 7/8 - -	21/32	7/16	15/16	0.7
AK26	2.60	2.40	2.06	B	1/2 - 5/8 - 3/4 - - -	21/32	7/16	15/16	0.7
AK27	2.70	2.50	2.16	B	1/2 - 5/8 - 3/4 - - - 1	21/32	7/16	15/16	0.8
AK28	2.80	2.60	2.26	B	1/2 - 5/8 - 3/4 - 7/8 - -	21/32	7/16	15/16	0.8
AK30	3.05	2.80	2.46	B	1/2 - 5/8 - 3/4 - 7/8 - - 1	21/32	7/16	15/16	0.9
AK32	3.25	3.00	2.66	B	1/2 - 5/8 - 3/4 - 7/8 - - 1	21/32	7/16	15/16	1.0
AK34	3.45	3.20	2.86	B	1/2 - 5/8 - 3/4 - 7/8 - - 1	21/32	7/16	15/16	1.1
AK35	3.55	3.30	2.96	B	1/2 - 5/8 - 3/4 - 7/8 - - 1	21/32	7/16	15/16	1.2
AK39	3.75	3.50	3.16	B	1/2 - 5/8 - 3/4 - 7/8 - 15/16 - 1	3/4	15/32	15/32	1.6
AK41	3.95	3.70	3.36	B	1/2 - 5/8 - 3/4 - 7/8 - 15/16 - 1 - 1 1/2	3/4	15/32	15/32	1.6
AK44	4.25	4.00	3.66	B	1/2 - 5/8 - 3/4 - 7/8 - 15/16 - 1 - 1 1/2	3/4	15/32	15/32	1.9
AK46	4.45	4.20	3.86	B	1/2 - 5/8 - 3/4 - 7/8 - 15/16 - 1 - 1 1/2	3/4	15/32	15/32	2.0
AK49	4.75	4.50	4.16	B	1/2 - 5/8 - 3/4 - 7/8 - 15/16 - 1 - 1 1/2	3/4	15/32	15/32	2.1
AK51	4.95	4.70	4.36	B	1/2 - 5/8 - 3/4 - 7/8 - - 1 - 1 1/2	3/4	15/32	15/32	2.2
AK54	5.25	5.00	4.66	B	1/2 - 5/8 - 3/4 - 7/8 - 15/16 - 1 - 1 1/2 - 1 3/4	3/4	15/32	15/32	2.4
AK56	5.45	5.20	4.86	B	1/2 - 5/8 - 3/4 - 7/8 - 15/16 - 1 - 1 1/2 - 1 3/4	3/4	15/32	15/32	2.5
AK59	5.75	5.50	5.16	C	1/2 - 5/8 - 3/4 - 7/8 - 15/16 - 1 - 1 1/2 - 1 3/4	3/4	15/32	15/32	2.7
AK61	5.95	5.70	5.36	C	1/2 - 5/8 - 3/4 - 7/8 - 15/16 - 1 - 1 1/2 - 1 3/4	3/4	15/32	15/32	2.8
AK64	6.25	6.00	5.66	C	1/2 - 5/8 - 3/4 - 7/8 - 15/16 - 1 - 1 1/2 - 1 3/4	3/4	15/32	15/32	3.0
AK66	6.45	6.20	5.86	C	- 5/8 - 3/4 - - - 1 - 1 1/2 -	3/4	15/32	15/32	3.0
AK69	6.75	6.50	6.16	C	- - 3/4 - - - 1 - 1 1/2 -	3/4	23/32	1 1/2	3.7
AK71	6.95	6.70	6.36	C	1/2 - 5/8 - 3/4 - - - 1 - 1 1/2 - - - 1 7/8	3/4	23/32	1 1/2	4.3
AK74	7.25	7.00	6.66	C	1/2 - 5/8 - 3/4 - - - 15/16 - 1 - 1 1/2 - 1 3/4 - - 1 7/8	3/4	23/32 *	1 1/2	4.5
AK79	7.75	7.50	7.16	C	- - - 3/4 - - - 1 - 1 1/2 - - - 1 7/8	3/4	23/32	1 1/2	4.7
AK81	7.95	7.70	7.36	C	- - 5/8 - 3/4 - - - 1 - - - 1 3/4 - - -	3/4	23/32	1 1/2	4.7
AK84	8.25	8.00	7.66	C	1/2 - 5/8 - 3/4 - - - 15/16 - 1 - - - 1 3/4 - - - 1 7/8	3/4	23/32 *	1 1/2	5.0
AK89	8.75	8.50	8.16	C	- - - 3/4 - - - 1 - 1 1/2 - - - 1 7/8	3/4	23/32	1 1/2	5.2
AK91	8.95	8.70	8.36	C	- - - 3/4 - - - 1 - - - - - - -	3/4	23/32	1 1/2	5.2
AK94	9.25	9.00	8.66	C	1/2 - 5/8 - 3/4 - - - 15/16 - 1 - - - 1 3/4 - - 1 7/8	3/4	23/32 *	1 1/2	5.5
AK99	9.75	9.50	9.16	C	- - - 3/4 - - - 1 - - - - - 1 7/8	3/4	23/32 *	1 1/2	5.7
AK104	10.25	10.00	9.66	C	- 5/8 - 3/4 - - - 1 - - - 1 3/4 - - 1 3/8 - 1 7/8	3/4	23/32	1 1/2	5.9
AK109	10.75	10.50	10.16	C	- - - 3/4 - - - 1 - - - - - 1 3/8 - 1 7/8	3/4	23/32	1 1/2	6.1
AK114	11.25	11.00	10.66	C	- - - 3/4 - - - 1 - - - 1 3/8 - - - 1 7/8	3/4	23/32 *	1 1/2	6.7
AK124	12.25	12.00	11.66	C	- 5/8 - 3/4 - - - 1 - - - 1 3/8 - 1 1/4 - - 1 7/8	3/4	23/32 *	1 1/2	7.3
AK134	13.25	13.00	12.66	C	- - - 3/4 - - - 1 - - - 1 3/8 - - - 1 3/8 - 1 7/8	3/4	23/32	1 1/2	8.2
AK144	14.25	14.00	13.66	C	- - - 3/4 - - - 1 - - - 1 3/8 - - - 1 7/8	3/4	23/32	1 1/2	8.7
AK154	15.25	15.00	14.66	C	- - - 3/4 - - - 1 - - - - - - - 1 7/8	3/4	23/32	1 1/2	9.7
AK184	18.25	18.00	17.66	C	- - - 3/4 - - - 1 - - - 1 3/8 - - - 1 7/8	3/4	23/32	1 1/2	11.8

\* E = 25/32 FOR BORE SIZES <= 1  
1/2" Bore - setscrew only - no keyway



# Two Groove FHP Sheaves Bored-To-Size **2AK**

## Keyway Dimensions Inch Bore

Diameter Of Shaft	Keyway Width X Depth
1/2	NONE
5/8 - 7/8	3/16 X 3/32
15/16 - 1-1/4	1/4 X 1/8
1-5/16 - 1-3/8	5/16 X 5/32
1-7/16 - 1-3/4	3/8 X 3/16

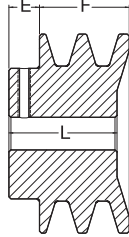

**TYPE A  
Solid**

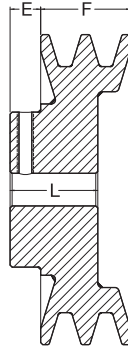

**TYPE B  
Web**

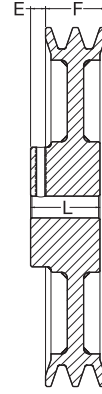

**TYPE C  
Arm / Spoke**



## Dimensions in inches

Part Number	Diameter			Type	Stock Finished Bores Includes Keyway and Setscrew	F	E	L Thru Bore	Weight Lbs. (Approx.)
	OD	Datum A(4L) Belts	Pitch 3L Belts						
2AK20	2.00	1.80	1.46	A	1/2 - 5/8 - 3/4	13/16	15/32	121/32	0.8
2AK21	2.15	1.90	1.56	A	1/2 - 5/8 - 3/4	13/16	15/32	121/32	0.9
2AK22	2.25	2.00	1.66	A	1/2 - 5/8 - 3/4 - 7/8 - - - 1	13/16	15/32	121/32	1.1
2AK23	2.35	2.10	1.76	A	- 5/8 - 3/4 - 7/8 - - - 1	13/16	15/32	121/32	1.2
2AK25	2.55	2.30	1.96	A	- 5/8 - 3/4 - 7/8 - - - 1	13/16	15/32	121/32	1.4
2AK26	2.65	2.40	2.06	A	- 5/8 - 3/4 - 7/8 - - - 1	13/16	15/32	121/32	1.5
2AK27	2.75	2.50	2.16	A	- 5/8 - 3/4 - 7/8 - - - 1	13/16	15/32	121/32	1.6
2AK28	2.85	2.60	2.26	A	- 5/8 - 3/4 - 7/8 - - - 1	13/16	15/32	121/32	1.7
2AK30	3.05	2.80	2.46	A	1/2 - 5/8 - 3/4 - 7/8 - - - 1 - 1 1/8	13/16	15/32	121/32	2.0
2AK32	3.25	3.00	2.66	A	5/8 - 3/4 - 7/8 - - - 1 - 1 1/8	13/16	15/32	121/32	2.2
2AK34	3.45	3.20	2.86	A	5/8 - 3/4 - 7/8 - - - 1 - 1 1/8	13/16	15/32	121/32	2.5
2AK39	3.75	3.50	3.16	B	5/8 - 3/4 - 7/8 - - - 1 - 1 1/8	13/16	15/32	111/32	2.6
2AK41	3.95	3.70	3.36	B	5/8 - 3/4 - 7/8 - - - 1 - 1 1/8	13/16	15/32	111/32	2.9
2AK44	4.25	4.00	3.66	B	5/8 - 3/4 - 7/8 - - - 1 - 1 1/8	13/16	15/32	111/32	3.3
2AK46	4.45	4.20	3.86	B	5/8 - - - 7/8 - - - 1 - 1 1/8	13/16	15/32	111/32	3.6
2AK49	4.75	4.50	4.16	B	- 3/4 - 7/8 - - - 1 - 1 1/8 - - - 1 3/8	13/16	15/32	111/32	4.1
2AK51	4.95	4.70	4.36	B	- 3/4 - 7/8 - - - 1 - 1 1/8 - - - 1 3/8	13/16	15/32	111/32	4.5
2AK54	5.25	5.00	4.66	B	5/8 - 3/4 - 7/8 - - - 1 - 1 1/8 - - - 1 3/8	13/16	15/32	111/32	4.1
2AK56	5.45	5.20	4.86	B	5/8 - 3/4 - - - - - 1 - 1 1/8 - - - 1 3/8	13/16	15/32	111/32	4.1
2AK59	5.75	5.50	5.16	B	- - - - - - - 1 - 1 1/8 - - - 1 3/8	13/16	15/32	111/32	4.3
2AK61	5.95	5.70	5.36	B	3/4 - 7/8 - - - 1 - 1 1/8 - - - 1 3/8	13/16	15/32	111/32	4.5
2AK64	6.25	6.00	5.66	C	3/4 - - - - 1 - 1 1/8 - 13/16 - 1 3/8 - 17/16	13/16	11/32	119/32	5.6
2AK74	7.25	7.00	6.66	C	3/4 - - - - 1 - 1 1/8 - 13/16 - 1 3/8 - 17/16	13/16	11/32	119/32	6.5
2AK84	8.25	8.00	7.66	C	3/4 - - - 15/16 - 1 - 1 1/8 - - - 1 3/8 - 17/16	13/16	11/32	119/32	7.2
2AK94	9.25	9.00	8.66	C	3/4 - 7/8 - - - 1 - 1 1/8 - 13/16 - 1 3/8 - 17/16	13/16	11/32	119/32	8.0
2AK104	10.25	10.00	9.66	C	3/4 - - - 15/16 - 1 - - - 13/16 - - - 17/16	13/16	11/32	119/32	9.0
2AK114	11.25	11.00	10.66	C	1 - - - - 13/16 - 1 3/8 - 17/16	13/16	11/32	119/32	9.7
2AK124	12.25	12.00	11.66	C	1 - - - - 13/16 - - - 17/16	13/16	11/32	119/32	10.5
2AK134	13.25	13.00	12.66	C	- - - - 13/16 - - - 17/16	13/16	11/32	119/32	12.7
2AK144	14.25	14.00	13.66	C	1 - - - - - - - 17/16	13/16	11/32	119/32	13.1
2AK154	15.25	15.00	14.66	C	13/16 - - - - 17/16	13/16	11/32	119/32	14.3
2AK184	18.25	18.00	17.66	C	13/16 - - - - 17/16	13/16	11/32	119/32	17.1

1/2" Bore - setscrew only - no keyway

# AK-H Single Groove FHP Sheaves MST® Bushed

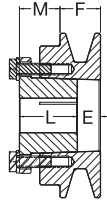

**TYPE A**  
Solid

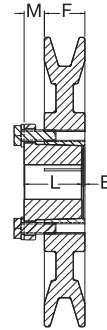

**TYPE B**  
Web

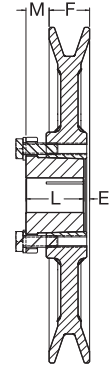

**TYPE C**  
Arm / Spoke

## Dimensions in inches, weight in pounds

Part Number	Diameter			Type	Bush	Bush Max. Bore	F	E	L Thru Bore	M	Weight Less Bush
	OD	Datum A(4L) Belts	Pitch 3L Belts								
AK30-H	3.05	2.80	2.46	A	H	1-1/2	3/4	3/8	1-1/4	7/8	1.3
AK32-H	3.25	3.00	2.66	A	H	1-1/2	3/4	3/8	1-1/4	7/8	1.4
AK34-H	3.45	3.20	2.86	A	H	1-1/2	3/4	1/16	1-1/4	9/16	1.2
AK39-H	3.75	3.50	3.16	A	H	1-1/2	3/4	1/16	1-1/4	9/16	1.4
AK41-H	3.95	3.70	3.36	A	H	1-1/2	3/4	1/16	1-1/4	9/16	1.6
AK44-H	4.25	4.00	3.66	A	H	1-1/2	3/4	1/16	1-1/4	9/16	2.0
AK46-H	4.45	4.20	3.86	A	H	1-1/2	3/4	1/16	1-1/4	9/16	2.2
AK49-H	4.75	4.50	4.16	B	H	1-1/2	3/4	1/16	1-1/4	9/16	2.1
AK51-H	4.95	4.70	4.36	B	H	1-1/2	3/4	1/16	1-1/4	9/16	2.3
AK54-H	5.25	5.00	4.66	B	H	1-1/2	3/4	1/16	1-1/4	9/16	2.3
AK56-H	5.45	5.20	4.86	B	H	1-1/2	3/4	1/16	1-1/4	9/16	2.4
AK59-H	5.75	5.50	5.16	B	H	1-1/2	3/4	1/16	1-1/4	9/16	2.5
AK61-H	5.95	5.70	5.36	C	H	1-1/2	3/4	1/16	1-1/4	9/16	2.6
AK64-H	6.25	6.00	5.66	C	H	1-1/2	3/4	1/16	1-1/4	9/16	2.8
AK66-H	6.45	6.20	5.86	C	H	1-1/2	3/4	1/16	1-1/4	9/16	2.8
AK69-H	6.75	6.50	6.16	C	H	1-1/2	3/4	1/16	1-1/4	9/16	3.0
AK71-H	6.95	6.70	6.36	C	H	1-1/2	3/4	1/16	1-1/4	9/16	3.0
AK74-H	7.25	7.00	6.66	C	H	1-1/2	3/4	1/16	1-1/4	9/16	3.3
AK79-H	7.75	7.50	7.16	C	H	1-1/2	3/4	1/16	1-1/4	9/16	3.5
AK84-H	8.25	8.00	7.66	C	H	1-1/2	3/4	1/16	1-1/4	9/16	3.8
AK89-H	8.75	8.50	8.16	C	H	1-1/2	3/4	1/16	1-1/4	9/16	4.0
AK94-H	9.25	9.00	8.66	C	H	1-1/2	3/4	1/16	1-1/4	9/16	4.4
AK99-H	9.75	9.50	9.16	C	H	1-1/2	3/4	1/16	1-1/4	9/16	4.7
AK104-H	10.25	10.00	9.66	C	H	1-1/2	3/4	1/16	1-1/4	9/16	5.0
AK109-H	10.75	10.50	10.16	C	H	1-1/2	3/4	1/16	1-1/4	9/16	5.2
AK114-H	11.25	11.00	10.66	C	H	1-1/2	3/4	1/16	1-1/4	9/16	5.5
AK124-H	12.25	12.00	11.66	C	H	1-1/2	3/4	1/16	1-1/4	9/16	6.0
AK134-H	13.25	13.00	12.66	C	H	1-1/2	3/4	1/16	1-1/4	9/16	7.3
AK144-H	14.25	14.00	13.66	C	H	1-1/2	3/4	1/16	1-1/4	9/16	7.9
AK154-H	15.25	15.00	14.66	C	H	1-1/2	3/4	1/16	1-1/4	9/16	8.9
AK184-H	18.25	18.00	17.66	C	H	1-1/2	3/4	1/16	1-1/4	9/16	11.4

Weights do not include bushings.



# Two Groove FHP Sheaves MST® Bushed 2AK-H

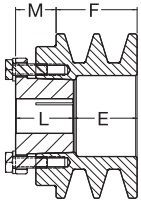

**TYPE A**  
Solid

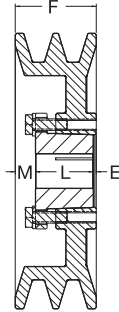

**TYPE B**  
Web

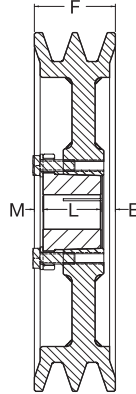

**TYPE C**  
Arm / Spoke



Dimensions in inches, weight in pounds

Part Number	Diameter			Type	Bush	Bush Max. Bore	F	E	L Thru Bore	M	Weight Less Bush
	OD	Datum A(4L) Belts	Pitch 3L Belts								
2AK30-H	3.05	2.80	2.46	A	H	1-1/2	1-3/8	1	1-1/4	7/8	1.7
2AK32-H	3.25	3.00	2.66	A	H	1-1/2	1-3/8	1	1-1/4	7/8	1.9
2AK34-H	3.45	3.20	2.86	A	H	1-1/2	1-3/8	9/16	1-1/4	7/16	1.7
2AK39-H	3.75	3.50	3.16	A	H	1-1/2	1-3/8	9/16	1-1/4	7/16	2.0
2AK41-H	3.95	3.70	3.36	B	H	1-1/2	1-3/8	1/16	1-1/4	1/16	2.2
2AK44-H	4.25	4.00	3.66	B	H	1-1/2	1-3/8	1/16	1-1/4	1/16	2.7
2AK46-H	4.45	4.20	3.86	B	H	1-1/2	1-3/8	1/16	1-1/4	1/16	3.0
2AK49-H	4.75	4.50	4.16	B	H	1-1/2	1-3/8	1/16	1-1/4	1/16	3.1
2AK51-H	4.95	4.70	4.36	B	H	1-1/2	1-3/8	1/16	1-1/4	1/16	3.5
2AK54-H	5.25	5.00	4.66	B	H	1-1/2	1-3/8	1/16	1-1/4	1/16	3.4
2AK56-H	5.45	5.20	4.86	B	H	1-1/2	1-3/8	1/16	1-1/4	1/16	3.6
2AK59-H	5.75	5.50	5.16	C	H	1-1/2	1-3/8	1/16	1-1/4	1/16	3.4
2AK61-H	5.95	5.70	5.36	C	H	1-1/2	1-3/8	1/16	1-1/4	1/16	3.7
2AK64-H	6.25	6.00	5.66	C	H	1-1/2	1-3/8	1/16	1-1/4	1/16	3.9
2AK74-H	7.25	7.00	6.66	C	H	1-1/2	1-3/8	1/16	1-1/4	1/16	5.0
2AK84-H	8.25	8.00	7.66	C	H	1-1/2	1-3/8	1/16	1-1/4	1/16	5.6
2AK94-H	9.25	9.00	8.66	C	H	1-1/2	1-3/8	1/16	1-1/4	1/16	6.3
2AK104-H	10.25	10.00	9.66	C	H	1-1/2	1-3/8	1/16	1-1/4	1/16	7.6
2AK114-H	11.25	11.00	10.66	C	H	1-1/2	1-3/8	1/16	1-1/4	1/16	8.4
2AK124-H	12.25	12.00	11.66	C	H	1-1/2	1-3/8	1/16	1-1/4	1/16	9.2
2AK134-H	13.25	13.00	12.66	C	H	1-1/2	1-3/8	1/16	1-1/4	1/16	11.5
2AK144-H	14.25	14.00	13.66	C	H	1-1/2	1-3/8	1/16	1-1/4	1/16	11.8
2AK154-H	15.25	15.00	14.66	C	H	1-1/2	1-3/8	1/16	1-1/4	1/16	13.3
2AK184-H	18.25	18.00	17.66	C	H	1-1/2	1-3/8	1/16	1-1/4	1/16	16.9

Weights do not include bushings.

## MST "H" Bushings – Inch Bore

Diameter Of Shaft	Keyway Width X Depth	Diameter Of Shaft	Keyway Width X Depth
3/8	NONE	1	1/4 X 1/8
7/16	NONE	1-1/16	1/4 X 1/8
1/2	1/8 X 1/16	1-1/8	1/4 X 1/8
9/16	1/8 X 1/16	1-3/16	1/4 X 1/8
19/32	1/8 X 1/16	1-1/4	1/4 X 1/8
5/8	3/16 X 3/32	1-5/16	5/16 X 1/16
21/32	3/16 X 3/32	1-3/8	5/16 X 1/16
11/16	3/16 X 3/32	1-3/8W	3/8 X 1/16
3/4	3/16 X 3/32	1-7/16	3/8 X 1/16
25/32	3/16 X 3/32	1-1/2	3/8 X 1/32
13/16	3/16 X 3/32		
7/8	3/16 X 3/32		
15/16	1/4 X 1/8		
31/32	1/4 X 1/8		

## MST "H" Bushings – Millimeter Bore

Diameter Of Shaft	Keyway Width X Depth	Diameter Of Shaft	Keyway Width X Depth
10	NONE	22	6 X 2.8
11	NONE	24	8 X 3.3
12	NONE	25	8 X 3.3
14	5 X 2.3	28	8 X 3.3
16	5 X 2.3	30	8 X 3.3
18	6 X 2.8	32	10 X 1.3
19	6 X 2.8	35	10 X 0.3
20	6 X 2.8	36	10 X 1.3
		38	10 X 0.3

# BK Single Groove FHP Sheaves Bored-To-Size

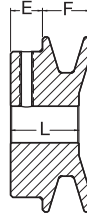

**TYPE A  
Solid**

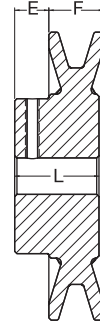

**TYPE B  
Web**

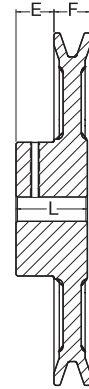

**TYPE C  
Arm / Spoke**

## Dimensions in inches

Part Number	Diameter			Type	Stock Finished Bores Includes Keyway and Setscrew	F	E	L Thru Bore	Weight Lbs. (Approx.)
	OD	Datum A(4L) Belts	Datum B(5L) Belts						
BK23	2.30	-	2.10	A	5/8 - - - - - 1	13/16	13/32	1 1/16	0.4
BK24	2.40	1.80	2.20	A	1/2 - 5/8 - 3/4 - 7/8 - - -	13/16	13/32	1 1/16	0.4
BK25	2.50	1.90	2.30	A	1/2 - 5/8 - 3/4 - 7/8 - - -	13/16	13/32	1 1/16	0.5
BK26	2.60	2.00	2.40	A	1/2 - 5/8 - 3/4 - 7/8 - - -	13/16	13/32	1 1/16	0.6
BK27	2.70	2.10	2.50	B	1/2 - 5/8 - 3/4 - 7/8 - - - 1 1/8	13/16	13/32	1 1/16	0.6
BK28	2.95	2.20	2.60	B	1/2 - 5/8 - 3/4 - 7/8 - - - 1 - 1 1/8	13/16	13/32	1 1/16	0.8
BK30	3.15	2.40	2.80	B	1/2 - 5/8 - 3/4 - 7/8 - - - 1 - 1 1/8	13/16	13/32	1 1/16	0.8
BK32	3.35	2.60	3.00	B	1/2 - 5/8 - 3/4 - 7/8 - - - 1 -	13/16	13/32	1 1/16	0.8
BK34	3.55	2.80	3.20	B	1/2 - 5/8 - 3/4 - 7/8 - - - 1 - 1 1/8	7/8	13/32	1 5/32	1.3
BK36	3.75	3.00	3.40	B	1/2 - 5/8 - 3/4 - 7/8 - - - 1 - 1 1/8	7/8	13/32	1 5/32	1.5
BK40	3.95	3.20	3.60	B	1/2 - 5/8 - 3/4 - 7/8 - - - 1 - 1 1/8	7/8	13/32	1 5/32	1.5
BK45	4.25	3.50	3.90	B	1/2 - 5/8 - 3/4 - 7/8 - - - 1 - 1 1/8	7/8	13/32	1 5/32	1.8
BK46	4.35	3.60	4.00	B	- - - - 7/8 - - - -	7/8	13/32	1 5/32	1.8
BK47	4.45	3.70	4.10	B	1/2 - 5/8 - 3/4 - 7/8 - - - 1 - 1 1/8	7/8	13/32	1 5/32	1.8
BK48	4.55	3.80	4.20	B	1/2 - 5/8 - 3/4 - 7/8 - - - 1 - 1 1/8	7/8	13/32	1 5/32	2.0
BK50	4.75	4.00	4.40	B	1/2 - 5/8 - 3/4 - 7/8 - 15/16 - 1 - 1 1/8	7/8	13/32	1 5/32	2.0
BK52	4.95	4.20	4.60	B	1/2 - 5/8 - 3/4 - 7/8 - - - 1 - 1 1/8	7/8	13/32	1 5/32	2.0
BK55	5.25	4.50	4.90	B	1/2 - 5/8 - 3/4 - 7/8 - - - 1 - 1 1/8 - 1 3/16	7/8	13/32	1 5/32	2.2
BK57	5.45	4.70	5.10	B	- 5/8 - 3/4 - 7/8 - 15/16 - 1 - 1 1/8 -	7/8	13/32	1 5/32	2.3
BK60	5.75	5.00	5.40	B	1/2 - 5/8 - 3/4 - 7/8 - - - 1 - 1 1/8 - 1 3/16	7/8	13/32	1 5/32	2.3
BK62	5.95	5.20	5.60	B	1/2 - 5/8 - 3/4 - 7/8 - 15/16 - 1 - 1 1/8 - 1 3/16	7/8	13/32	1 5/32	2.4
BK65	6.25	5.50	5.90	B	5/8 - 3/4 - 7/8 - - - 1 - 1 1/8 -	7/8	13/32	1 5/32	2.7
BK67	6.45	5.70	6.10	C	5/8 - 3/4 - 7/8 - - - 1 - 1 1/8 -	7/8	13/32	1 5/32	2.8
BK70	6.75	6.00	6.40	C	5/8 - 3/4 - 7/8 - 15/16 - 1 - 1 1/8 - 1 3/16 - - - 1 7/16	7/8	2 1/32 *	1 5/32	3.3
BK72	6.95	6.20	6.60	C	- 3/4 - - - - 1 - 1 1/8 - - - 1 3/8 - 1 7/16	7/8	2 1/32	1 5/32	3.9
BK75	7.25	6.50	6.90	C	- 3/4 - - - - 1 - 1 1/8 - - - - 1 7/16	7/8	2 1/32	1 5/32	3.9
BK77	7.45	6.70	7.10	C	- 3/4 - - - - 1 - 1 1/8 - - - - 1 3/8 - 1 7/16	7/8	2 1/32	1 5/32	4.1
BK80	7.75	7.00	7.40	C	5/8 - 3/4 - 7/8 - - - 1 - 1 1/8 - 1 3/16 - 1 1/4 - 1 3/8 - 1 7/16	7/8	2 1/32	1 5/32	4.4
BK85	8.25	7.50	7.90	C	3/4 - - - - 1 - 1 1/8 - 1 3/16 - - - 1 3/8 - 1 7/16	7/8	2 1/32	1 5/32	5.0
BK90	8.75	8.00	8.40	C	3/4 - 7/8 - 15/16 - 1 - 1 1/8 - 1 3/16 - - - 1 3/8 - 1 7/16	7/8	2 1/32	1 5/32	5.0
BK95	9.25	8.50	8.90	C	3/4 - - - - 1 - 1 1/8 - - - - 1 3/8 - 1 7/16	7/8	2 1/32	1 5/32	5.4
BK100	9.75	9.00	9.40	C	3/4 - 7/8 - - - 1 - 1 1/8 - 1 3/16 - 1 1/4 - 1 3/8 - 1 7/16	7/8	2 1/32	1 5/32	5.6
BK105	10.25	9.50	9.90	C	- - - - 1 - - - - - 1 3/8 - 1 7/16	7/8	2 1/32	1 5/32	5.8
BK110	10.75	10.00	10.40	C	3/4 - - - - 1 - 1 1/8 - 1 3/16 - - - 1 3/8 - 1 7/16	7/8	2 1/32	1 5/32	6.4
BK115	11.25	10.50	10.90	C	- - - - 1 - - - - - 1 3/8 - 1 7/16	7/8	2 1/32	1 5/32	6.9
BK120	11.75	11.00	11.40	C	3/4 - - - - 1 - - - 1 3/16 - - - 1 3/8 - 1 7/16	7/8	2 1/32	1 5/32	7.4
BK130	12.75	12.00	12.40	C	3/4 - 7/8 - - - 1 - 1 1/8 - 1 3/16 - - - 1 7/16	7/8	2 1/32	1 5/32	8.4
BK140	13.75	13.00	13.40	C	3/4 - - - - 1 - - - 1 3/16 - - - 1 7/16	7/8	2 1/32	1 5/32	9.4
BK160	15.75	15.00	15.40	C	1 - 1 1/8 - 1 3/16 - 1 1/4 - - - 1 7/16	7/8	2 1/32	1 5/32	11.4
BK190	18.75	18.00	18.40	C	1 - - - 1 3/16 - 1 1/4 - - - 1 7/16	7/8	2 1/32	1 5/32	13.4

\* E = 13/32 FOR BORE SIZES <= 1  
1/2" Bore - setscrew only - no keyway



# Two Groove FHP Sheaves Bored-To-Size **2BK**

## Keyway Dimensions Inch Bore

Diameter Of Shaft	Keyway Width X Depth
1/2	NONE
5/8 - 7/8	3/16 X 3/32
15/16 - 1-1/4	1/4 X 1/8
1-5/16 - 1-3/8	5/16 X 5/32
1-7/16 - 1-3/4	3/8 X 3/16

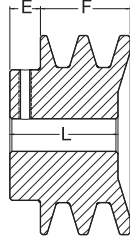

**TYPE A**  
Solid

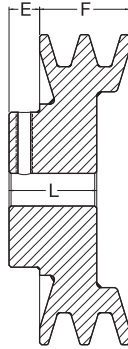

**TYPE B**  
Web

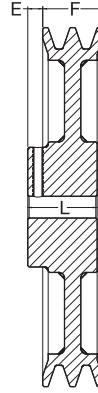

**TYPE C**  
Arm / Spoke



## Dimensions in inches

Part Number	Diameter			Type	Stock Finished Bores Includes Keyway and Setscrew	F	E	L Thru Bore	Weight Lbs. (Approx.)
	OD	Datum A(4L) Belts	Datum B(5L) Belts						
2BK25	2.50	1.90	2.30	A	1/2 - 5/8 - 3/4 - 7/8	13/4	15/32	131/32	1.3
2BK26	2.60	2.00	2.40	A	- 5/8 - - 7/8 - - 1 1/8	13/4	15/32	131/32	1.5
2BK27	2.70	2.10	2.50	A	1/2 - 5/8 - 3/4 - 7/8 - 1 -	13/4	15/32	131/32	1.6
2BK28	2.95	2.20	2.60	A	1/2 - 5/8 - 3/4 - 7/8 - 1 - 1 1/8	13/4	15/32	131/32	1.9
2BK30	3.15	2.40	2.80	A	1/2 - 5/8 - 3/4 - 7/8 - 1 - 1 1/8	13/4	15/32	131/32	2.3
2BK32	3.35	2.60	3.00	A	5/8 - - - 7/8 - 1 - 1 1/8	13/4	15/32	131/32	2.6
2BK34	3.55	2.80	3.20	A	5/8 - 3/4 - 7/8 - 1 - 1 1/8	13/4	15/32	131/32	2.8
2BK36	3.75	3.00	3.40	A	- 3/4 - 7/8 - 1 - 1 1/8 - - 1 3/8	13/4	15/32	131/32	3.3
2BK40	3.95	3.20	3.60	B	5/8 - 3/4 - 7/8 - 1 - 1 1/8 - -	13/4	15/32	115/32	3.3
2BK45	4.25	3.50	3.90	B	- - - 1 - 1 1/8 - - 1 3/8	13/4	15/32	115/32	3.3
2BK47	4.45	3.70	4.10	B	- 7/8 - 1 - 1 1/8 - -	13/4	15/32	115/32	3.7
2BK50	4.75	4.00	4.40	B	3/4 - - 1 - 1 1/8 - - 1 3/8	13/4	15/32	115/32	4.1
2BK52	4.95	4.20	4.60	B	- 7/8 - 1 - 1 1/8 - - 1 3/8	13/4	15/32	115/32	4.5
2BK55	5.25	4.50	4.90	B	- - - 1 1/8 - - 1 3/8	13/4	15/32	115/32	4.5
2BK57	5.45	4.70	5.10	B	- - - 1 - 1 1/8 - - 1 3/8	13/4	15/32	115/32	5.1
2BK60	5.75	5.00	5.40	B	3/4 - 7/8 - 1 - 1 1/8 - - 1 3/8	13/4	15/32	115/32	4.9
2BK62	5.95	5.20	5.60	B	- - - 1 - 1 1/8 - - 1 3/8	13/4	15/32	115/32	4.8
2BK65	6.25	5.50	5.90	B	- - - 1 - 1 1/8 - - 1 3/8	13/4	15/32	115/32	5.0
2BK67	6.45	5.70	6.10	C	- - - 1 - 1 1/8 - - 1 3/8	13/4	15/32	115/32	5.0
2BK70	6.75	6.00	6.40	C	3/4 - - 1 - 1 1/8 - 13/16 - 1 3/8 - 17/16	13/4	11/32	115/32	6.6
2BK80	7.75	7.00	7.40	C	3/4 - - 1 - 1 1/8 - 13/16 - 1 3/8 - 17/16	13/4	11/32	115/32	7.2
2BK90	8.75	8.00	8.40	C	3/4 - - 1 - 1 1/8 - 13/16 - 1 3/8 - 17/16	13/4	11/32	115/32	8.4
2BK100	9.75	9.00	9.40	C	3/4 - - 1 - - - 13/16 - 1 3/8 - 17/16	13/4	11/32	115/32	9.4
2BK110	10.75	10.00	10.40	C	- - - 1 - - - 13/16 - - 17/16	13/4	11/32	115/32	10.4
2BK120	11.75	11.00	11.40	C	- - - 1 - - - 13/16 - - 17/16	13/4	11/32	115/32	11.8
2BK130	12.75	12.00	12.40	C	- - - 1 - - - 13/16 - - 17/16	13/4	11/32	115/32	14.9
2BK140	13.75	13.00	13.40	C	- - - 1 - - - 13/16 - - 17/16	13/4	11/32	115/32	16.3
2BK160	15.75	15.00	15.40	C	- - - 1 - - - 13/16 - - 17/16	13/4	11/32	115/32	18.0
2BK190	18.75	18.00	18.40	C	- - - 1 - - - 13/16 - - 17/16	13/4	11/32	115/32	23.3

1/2" Bore - setscrew only - no keyway

# BK-H Single Groove FHP Sheaves

## MST® Bushed

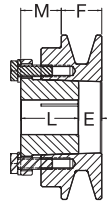

**TYPE A**  
Solid

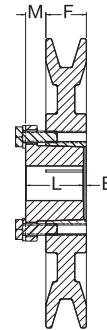

**TYPE B**  
Web

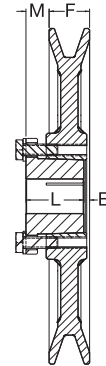

**TYPE C**  
Arm / Spoke

### Dimensions in inches, weight in pounds

Part Number	Diameter			Type	Bush	Bush Max. Bore	F	E	L Thru Bore	M	Weight Less Bush
	OD	Datum A(4L) Belts	Datum B(5L) Belts								
BK30-H	3.15	2.40	2.80	A	H	1-1/2	7/8	1/2	1-1/4	7/8	1.3
BK32-H	3.35	2.60	3.00	A	H	1-1/2	7/8	1/2	1-1/4	7/8	1.5
BK34-H	3.55	2.80	3.20	A	H	1-1/2	7/8	1/2	1-1/4	7/8	1.7
BK36-H	3.75	3.00	3.40	B	H	1-1/2	7/8	1/16	1-1/4	7/16	1.3
BK40-H	3.95	3.20	3.60	B	H	1-1/2	7/8	1/16	1-1/4	7/16	1.5
BK45-H	4.25	3.50	3.90	B	H	1-1/2	7/8	1/16	1-1/4	7/16	1.9
BK47-H	4.45	3.70	4.10	B	H	1-1/2	7/8	1/16	1-1/4	7/16	2.2
BK50-H	4.75	4.00	4.40	B	H	1-1/2	7/8	1/16	1-1/4	7/16	2.2
BK52-H	4.95	4.20	4.60	B	H	1-1/2	7/8	1/16	1-1/4	7/16	2.5
BK55-H	5.25	4.50	4.90	B	H	1-1/2	7/8	1/16	1-1/4	7/16	3.0
BK57-H	5.45	4.70	5.10	B	H	1-1/2	7/8	1/16	1-1/4	7/16	3.2
BK60-H	5.75	5.00	5.40	B	H	1-1/2	7/8	1/16	1-1/4	7/16	3.2
BK62-H	5.95	5.20	5.60	B	H	1-1/2	7/8	1/16	1-1/4	7/16	3.6
BK65-H	6.25	5.50	5.90	B	H	1-1/2	7/8	1/16	1-1/4	7/16	4.0
BK67-H	6.45	5.70	6.10	B	H	1-1/2	7/8	1/16	1-1/4	7/16	4.2
BK70-H	6.75	6.00	6.40	C	H	1-1/2	7/8	1/8	1-1/4	1/2	3.3
BK72-H	6.95	6.20	6.60	C	H	1-1/2	7/8	1/8	1-1/4	1/2	3.6
BK75-H	7.25	6.50	6.90	C	H	1-1/2	7/8	1/8	1-1/4	1/2	3.4
BK77-H	7.45	6.70	7.10	C	H	1-1/2	7/8	1/8	1-1/4	1/2	3.7
BK80-H	7.75	7.00	7.40	C	H	1-1/2	7/8	1/8	1-1/4	1/2	4.0
BK85-H	8.25	7.50	7.90	C	H	1-1/2	7/8	1/8	1-1/4	1/2	4.1
BK90-H	8.75	8.00	8.40	C	H	1-1/2	7/8	1/8	1-1/4	1/2	4.5
BK95-H	9.25	8.50	8.90	C	H	1-1/2	7/8	1/8	1-1/4	1/2	4.8
BK100-H	9.75	9.00	9.40	C	H	1-1/2	7/8	1/8	1-1/4	1/2	5.1
BK105-H	10.25	9.50	9.90	C	H	1-1/2	7/8	1/8	1-1/4	1/2	5.4
BK110-H	10.75	10.00	10.40	C	H	1-1/2	7/8	1/8	1-1/4	1/2	6.0
BK115-H	11.25	10.50	10.90	C	H	1-1/2	7/8	1/8	1-1/4	1/2	6.3
BK120-H	11.75	11.00	11.40	C	H	1-1/2	7/8	1/8	1-1/4	1/2	6.6
BK130-H	12.75	12.00	12.40	C	H	1-1/2	7/8	1/8	1-1/4	1/2	7.2
BK140-H	13.75	13.00	13.40	C	H	1-1/2	7/8	1/8	1-1/4	1/2	8.6
BK150-H	14.75	14.00	14.40	C	H	1-1/2	7/8	1/8	1-1/4	1/2	9.4
BK160-H	15.75	15.00	15.40	C	H	1-1/2	7/8	1/8	1-1/4	1/2	10.1
BK190-H	18.75	18.00	18.40	C	H	1-1/2	7/8	1/8	1-1/4	1/2	12.3

Weights do not include bushings.





# Two Groove FHP Sheaves MST® Bushed 2BK-H

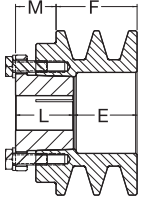

**TYPE A**  
Solid

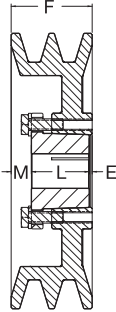

**TYPE B**  
Web

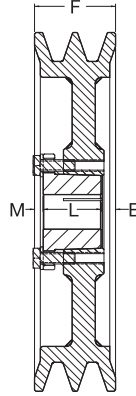

**TYPE C**  
Arm / Spoke



Dimensions in inches, weight in pounds

Part Number	Diameter			Type	Bush	Bush Max. Bore	F	E	L Thru Bore	M	Weight Less Bush
	OD	Datum A(4L) Belts	Datum B(5L) Belts								
2BK32-H	3.35	2.60	3.00	A	H	1 1/2	1 3/4	1 3/8	1 1/4	7/8	2.2
2BK34-H	3.55	2.80	3.20	A	H	1 1/2	1 3/4	1 3/8	1 1/4	7/8	2.6
2BK36-H	3.75	3.00	3.40	A	H	1 1/2	1 3/4	15/16	1 1/4	7/16	2.4
2BK40-H	3.95	3.20	3.60	A	H	1 1/2	1 3/4	15/16	1 1/4	7/16	2.6
2BK45-H	4.25	3.50	3.90	A	H	1 1/2	1 3/4	15/16	1 1/4	7/16	3.1
2BK47-H	4.45	3.70	4.10	B	H	1 1/2	1 3/4	1/16	1 1/4	7/16	3.2
2BK50-H	4.75	4.00	4.40	B	H	1 1/2	1 3/4	1/16	1 1/4	7/16	3.7
2BK52-H	4.95	4.20	4.60	B	H	1 1/2	1 3/4	1/16	1 1/4	7/16	4.1
2BK55-H	5.25	4.50	4.90	B	H	1 1/2	1 3/4	1/16	1 1/4	7/16	4.2
2BK57-H	5.45	4.70	5.10	B	H	1 1/2	1 3/4	1/16	1 1/4	7/16	4.5
2BK60-H	5.75	5.00	5.40	B	H	1 1/2	1 3/4	1/16	1 1/4	7/16	4.9
2BK62-H	5.95	5.20	5.60	B	H	1 1/2	1 3/4	1/16	1 1/4	7/16	5.2
2BK65-H	6.25	5.50	5.90	C	H	1 1/2	1 3/4	5/16	1 1/4	3/16	5.7
2BK67-H	6.45	5.70	6.10	C	H	1 1/2	1 3/4	5/16	1 1/4	3/16	5.8
2BK70-H	6.75	6.00	6.40	C	H	1 1/2	1 3/4	5/16	1 1/4	3/16	6.1
2BK72-H	6.95	6.20	6.60	C	H	1 1/2	1 3/4	5/16	1 1/4	3/16	6.1
2BK80-H	7.75	7.00	7.40	C	H	1 1/2	1 3/4	5/16	1 1/4	3/16	7.4
2BK90-H	8.75	8.00	8.40	C	H	1 1/2	1 3/4	5/16	1 1/4	3/16	8.5
2BK100-H	9.75	9.00	9.40	C	H	1 1/2	1 3/4	5/16	1 1/4	3/16	9.7
2BK110-H	10.75	10.00	10.40	C	H	1 1/2	1 3/4	5/16	1 1/4	3/16	10.9
2BK120-H	11.75	11.00	11.40	C	H	1 1/2	1 3/4	5/16	1 1/4	3/16	12.0
2BK130-H	12.75	12.00	12.40	C	H	1 1/2	1 3/4	5/16	1 1/4	3/16	13.4
2BK140-H	13.75	13.00	13.40	C	H	1 1/2	1 3/4	5/16	1 1/4	3/16	15.3
2BK160-H	15.75	15.00	15.40	C	H	1 1/2	1 3/4	5/16	1 1/4	3/16	17.8
2BK190-H	18.75	18.00	18.40	C	H	1 1/2	1 3/4	5/16	1 1/4	3/16	22.8

Weights do not include bushings.

## MST "H" Bushings – Inch Bore

Diameter Of Shaft	Keyway Width X Depth	Diameter Of Shaft	Keyway Width X Depth
3/8	NONE	1	1/4 X 1/8
7/16	NONE	1-1/16	1/4 X 1/8
1/2	1/8 X 1/16	1-1/8	1/4 X 1/8
9/16	1/8 X 1/16	1-3/16	1/4 X 1/8
19/32	1/8 X 1/16	1-1/4	1/4 X 1/8
5/8	3/16 X 3/32	1-5/16	5/16 X 1/16
21/32	3/16 X 3/32	1-3/8	5/16 X 1/16
11/16	3/16 X 3/32	1-3/8W	3/8 X 1/16
3/4	3/16 X 3/32	1-7/16	3/8 X 1/16
25/32	3/16 X 3/32	1-1/2	3/8 X 1/32
13/16	3/16 X 3/32		
7/8	3/16 X 3/32		
15/16	1/4 X 1/8		
31/32	1/4 X 1/8		

## MST "H" Bushings – Millimeter Bore

Diameter Of Shaft	Keyway Width X Depth	Diameter Of Shaft	Keyway Width X Depth
10	NONE	22	6 X 2.8
11	NONE	24	8 X 3.3
12	NONE	25	8 X 3.3
14	5 X 2.3	28	8 X 3.3
16	5 X 2.3	30	8 X 3.3
18	6 X 2.8	32	10 X 1.3
19	6 X 2.8	35	10 X 0.3
20	6 X 2.8	36	10 X 1.3
		38	10 X 0.3

# 1VP Single Groove Variable Pitch Sheaves – Bored-To-Size

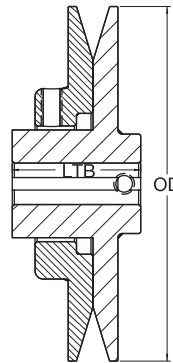

TYPE A

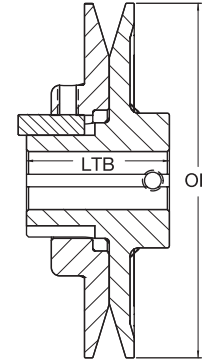

TYPE B

## Dimensions in inches

Part Number	Diameters And Turns															
	3L Belts				A or 4L Belts				B or 5L Belts				5V Belts			
	Min. Pitch	Turns Open	Max. Pitch	Turns Open	Min. Datum	Turns Open	Max. Datum	Turns Open	Min. Datum	Turns Open	Max. Datum	Turns Open	Min. Pitch	Turns Open	Max. Pitch	Turns Open
1VP25	1.6	4	2.4	0	-	-	-	-	-	-	-	-	-	-	-	-
1VP30	1.8	4	2.7	0	-	-	-	-	-	-	-	-	-	-	-	-
1VP34	1.9	4	2.8	0	2.0	5	3.0	0	2.3	5	3.2	1	-	-	-	-
1VP40	2.4	4	3.2	0	2.5	5	3.5	0	2.6	6	3.6	1	-	-	-	-
1VP44	2.8	4	3.7	0	2.9	5	3.9	0	3.0	6	4.0	1	-	-	-	-
1VP50	3.4	4	4.2	0	3.5	5	4.5	0	3.6	6	4.6	1	-	-	-	-
1VP56	4.0	4	4.8	0	4.1	5	5.1	0	4.2	6	5.2	1	-	-	-	-
1VP60	-	-	-	-	4.2	5	5.2	0	4.4	6	5.6	0	-	-	-	-
1VP62	4.6	4	5.4	0	4.7	5	5.7	0	4.8	6	5.8	1	5.1	6	6.1	1
1VP65	-	-	-	-	4.7	5	5.7	0	4.9	6	6.1	0	5.1	6	6.3	0
1VP68	5.2	4	6.0	0	5.3	5	6.3	0	5.4	6	6.4	1	5.7	6	6.7	1
1VP71	-	-	-	-	5.3	5	6.3	0	5.5	6	6.7	0	5.7	6	6.9	0
1VP75	-	-	-	-	5.7	5	6.7	0	5.9	6	7.1	0	6.1	6	7.3	0

## Dimensions in inches

Part Number	OD	Type	L Thru Bore	Stock Finished Bores Includes Keyway and Setscrew												Wt. Lbs. (Approx.)	
				1/2	5/8	3/4	7/8	1	1-1/8	1-1/4	1-3/8	1-1/2	1-5/8	1-3/4			
1VP25	2.50	A	1-23/32	1/2	-	5/8	-	3/4	-	-	-	-	-	-	-	-	0.8
1VP30	2.87	A	1-11/16	1/2	-	5/8	-	3/4	-	-	-	-	-	-	-	-	1.1
1VP34	3.15	A	1-29/32	1/2	-	5/8	-	3/4	-	7/8	-	-	-	-	-	-	1.4
1VP40	3.75	A	1-7/8	1/2	-	5/8	-	3/4	-	7/8	-	-	-	-	-	-	1.7
1VP44	4.15	A	1-7/8	1/2	-	5/8	-	3/4	-	-	-	-	-	-	-	-	2.4
1VP44	4.15	B	2-3/16	-	-	-	-	-	7/8	-	1	-	1-1/8	-	-	-	3.0
1VP50	4.75	A	2	1/2	-	5/8	-	3/4	-	-	-	-	-	-	-	-	2.7
1VP50	4.75	B	2-5/32	-	-	-	-	-	7/8	-	1	-	1-1/8	-	-	-	3.5
1VP56	5.35	A	1-15/16	1/2	-	5/8	-	3/4	-	-	-	-	-	-	-	-	4.1
1VP56	5.35	B	2-5/32	-	-	-	-	-	7/8	-	1	-	1-1/8	-	-	-	4.4
1VP60	6.00	B	2-7/32	-	5/8	-	3/4	-	7/8	-	1	-	1-1/8	-	-	1-3/8	6.3
1VP62	5.95	B	1-29/32	-	5/8	-	3/4	-	7/8	-	1	-	1-1/8	-	1-1/4	-	6.1
1VP65	6.50	B	2-7/32	-	-	-	3/4	-	7/8	-	-	-	1-1/8	-	-	1-3/8	7.1
1VP68	6.55	B	1-29/32	-	5/8	-	3/4	-	7/8	-	1	-	1-1/8	-	1-1/4	-	7.3
1VP71	7.10	B	2-7/32	-	-	-	3/4	-	7/8	-	-	-	1-1/8	-	-	1-3/8	8.2
1VP75	7.50	B	2-7/32	-	-	-	3/4	-	7/8	-	1	-	1-1/8	-	-	1-3/8	9.0

1/2" Bore - setscrew only - no keyway



# Two Groove Variable Pitch Sheaves – Bored-To-Size **2VP**

## Keyway Dimensions Inch Bore

Diameter Of Shaft	Keyway Width X Depth
1/2	NONE
5/8 - 7/8	3/16 X 3/32
15/16 - 1-1/4	1/4 X 1/8
1-5/16 - 1-3/8	5/16 X 5/32
1-7/16 - 1-3/4	3/8 X 3/16

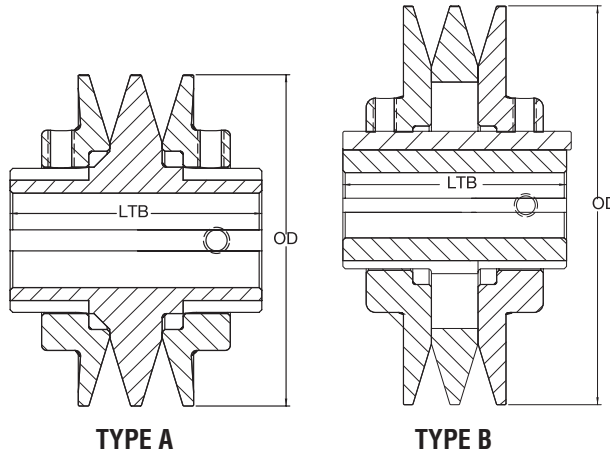

## Dimensions in inches

Part Number	Diameters And Turns															
	3L Belts				A or 4L Belts				B or 5L Belts				5V Belts			
	Min. Pitch	Turns Open	Max. Pitch	Turns Open	Min. Datum	Turns Open	Max. Datum	Turns Open	Min. Datum	Turns Open	Max. Datum	Turns Open	Min. Pitch	Turns Open	Max. Pitch	Turns Open
2VP36	2.0	4	2.8	0	2.1	5	3.1	0	2.4	5	3.2	1	-	-	-	-
2VP42	2.6	4	3.4	0	2.7	5	3.7	0	2.8	6	3.8	1	-	-	-	-
2VP50	3.4	4	4.2	0	3.5	5	4.5	0	3.6	6	4.6	1	-	-	-	-
2VP56	4.0	4	4.8	0	4.1	5	5.1	0	4.2	6	5.2	1	-	-	-	-
2VP60	-	-	-	-	4.2	5	5.2	0	4.4	6	5.6	0	-	-	-	-
2VP62	4.6	4	5.4	0	4.7	5	5.7	0	4.8	6	5.8	1	5.1	6	6.1	1
2VP65	-	-	-	-	4.7	5	5.7	0	4.9	6	6.1	0	5.1	6	6.3	0
2VP68	5.2	4	6.0	0	5.3	5	6.3	0	5.4	6	6.4	1	5.7	6	6.7	1
2VP71	-	-	-	-	5.3	5	6.3	0	5.5	6	6.7	0	5.7	6	6.9	0
2VP75	-	-	-	-	5.7	5	6.7	0	5.9	6	7.1	0	6.1	6	7.3	0

## Dimensions in inches

Part Number	OD	Type	L Thru Bore	Stock Finished Bores Includes Keyway and Setscrew												Wt. Lbs. (Approx.)	
				1/2	5/8	3/4	7/8	1	1-1/8	1-1/4	1-3/8	1-1/2	1-5/8	1-3/4			
2VP36	3.35	A	3	1/2	-	5/8	-	3/4	-	7/8	-	1	-	-	-	-	3.6
2VP42	3.95	A	3	-	5/8	-	3/4	-	7/8	-	1	-	1-1/8	-	-	-	4.5
2VP50	4.75	B	3	-	5/8	-	3/4	-	7/8	-	1	-	1-1/8	-	-	-	6.1
2VP56	5.35	B	3	-	5/8	-	3/4	-	7/8	-	1	-	1-1/8	-	-	-	7.5
2VP60	6.00	B	3-1/4	-	-	-	3/4	-	7/8	-	1	-	1-1/8	-	-	1-3/8	10.9
2VP62	5.95	B	3	-	-	-	3/4	-	7/8	-	1	-	1-1/8	-	-	1-3/8	10.0
2VP65	6.50	B	3-1/4	-	-	-	3/4	-	7/8	-	1	-	1-1/8	-	-	1-3/8	12.5
2VP68	6.55	B	3	-	-	-	3/4	-	7/8	-	1	-	1-1/8	-	1-1/4	-	11.7
2VP71	7.10	B	3-1/4	-	-	-	3/4	-	7/8	-	1	-	1-1/8	-	-	1-3/8	14.7
2VP75	7.50	B	3-1/4	-	-	-	3/4	-	7/8	-	1	-	1-1/8	-	-	1-3/8	16.3

1/2" Bore - setscrew only - no keyway



**INVENTORY:** *Martin* delivers with incredible fill rates from one of its many facilities strategically located across North America.



**SERVICE:** *Martin* ships rebore and other alterations within hours - not days... MTO's in days - not weeks.



**PEOPLE:** When you call *Martin* you get a person, not voice mail. We are ready, able and willing to help...Now!

## For more information contact a branch near you:

### USA

#### General Offices

#### Sales and Manufacturing

#### Arlington, TX

3100 Sprocket Drive 76015-2898  
P.O. Box 91588  
Arlington, TX 76015-0088  
817-258-3000 (FAX 817-258-3333)

#### Regional Manufacturing Plants

#### Albemarle, NC (Conveyor Pulley Div.)

306 Bethany Road  
Albemarle, NC 28001-8520  
704-982-9555 (FAX 704-982-9599)

#### Burleson, TX

555 N. Burleson Blvd.  
Burleson, TX 76028  
817-295-7151 (FAX 817-447-3840)

#### Danielsville, PA

3376 Delps Road 18038-9515  
P.O. Box 267 • Danielsville, PA 18038-0267  
610-837-1841 (FAX 610-837-7337)

#### Ft. Worth, TX (Conveyor Div.)

3600 McCart Avenue  
Ft. Worth, TX 76110-4692  
817-258-3000 (FAX 817-258-3173)

#### Ft. Worth, TX (Tool & Forge Div.)

3600 McCart Avenue  
Ft. Worth, TX 76110-4692  
817-258-3000 (FAX 817-258-3173)

#### Montpelier, OH

350 S. Airport Road  
Montpelier, OH 43543-9329  
419-485-5515 (FAX 419-485-3565)

#### Sacramento, CA

1199 Vine Street  
Sacramento, CA 95814-0426  
916-441-7172 (FAX 916-441-4600)

#### Scottsdale, GA

3303 Church Street 30079-1395  
P.O. Box 886 • Scottsdale, GA 30079-0886  
404-292-8744 (FAX 404-292-7771)

#### Branch Manufacturing Centers

#### Boston, MA

357 Fortune Boulevard  
Milford, MA 01757-1723  
508-634-3990 (FAX 508-634-3998)

#### Charlotte, NC

3901 Scott Futrell Drive  
Charlotte, NC 28208-3539  
704-394-9111 (FAX 704-394-9122)

#### Chicago, IL

1505 Birchwood Avenue  
Des Plaines, IL 60018-3001  
847-298-8844 (FAX 847-298-2967)

#### Denver, CO

10800 East 54th Avenue  
Denver CO 80239-2124  
303-371-8466 (FAX 303-371-7116)

#### Houston, TX

9910 Bent Oak Drive  
Houston, TX 77040-3222  
713-849-4330 (FAX 713-849-4807)

#### Kansas City, MO

1520 North Commerce Avenue  
Kansas City, MO 64120-4961  
816-231-5575 (FAX 816-231-1959)

#### Los Angeles, CA

5920 South Triangle Drive  
Commerce, CA 90040-3639  
323-728-8117 (FAX 323-722-7526)

#### Minneapolis, MN

10601 Hampshire Avenue South  
Bloomington, MN 55438-2395  
952-829-0623 (FAX 952-944-9385)

#### Nashville, TN

732 Massman Drive  
Nashville, Tennessee 37210  
615-871-4730 (FAX 615-871-4125)

#### Portland, OR

3030 Northwest Industrial Street  
Portland, OR 97210-1734  
503-223-7261 (FAX 503-221-0203)

#### Tampa, FL

3201 Queen Palm Drive  
Tampa FL 33619-1331  
813-623-1705 (FAX 813-626-8953)

#### Wayne, NJ

7 High Point Drive  
Wayne, NJ 07470-7432  
973-633-5700 (FAX 973-633-7196)

#### Manufacturing Only

#### Abilene, TX • Clarksville, TX

#### Dallas, TX • Mansfield, TX

#### Paragould, AR

### CANADA

#### Sales and Manufacturing

#### *Martin* Sprocket & Gear Canada Inc.

#### Edmonton, Alberta

4023/4027 53rd Avenue,  
Edmonton, Alberta, Canada T6B 3C6  
780-450-0888 (Fax 780-465-0079)

#### Mississauga, Ontario

896 Meyerside Drive  
Mississauga, Ontario, Canada L5T 1R9  
905-670-1991 (FAX 905-670-2110)

#### Ayr, Ontario (Conveyor Div.)

320 Darrell Drive  
Ayr, Ontario, Canada N0B 1E0  
519-621-0546 (FAX 519-621-4413)

### MEXICO

#### Sales and Manufacturing

#### *Martin* Sprocket & Gear de México, S.A. de C.V.

#### Guadalajara, JAL

Av. Colón Sur No. 6013, Edificio 1 Modulo 2  
Colonia Santa María Tequepexpan  
Tlaquepaque, Jalisco Mexico 45601  
+52 33-3283-1188 (martin76@martinsprocket.com)

#### Monterrey, N.L.

Av. Industrial No. 100  
Lote 6 y 7, Manzana 11  
Parque Industrial La Silla Apodaca  
Apodaca, N.L. México 66648  
+52 811 156 6830 (martin75@martinsprocket.com)

#### Toluca, MEX

Km 52 Carretera, Naucalpan-Toluca  
Calle 3, Manzana VII, Lote 11  
Parque Industrial Toluca 2000  
Toluca, Edo. de México 50233  
+52 722 276 0800 (martin74@martinsprocket.com)

### SOUTH AMERICA

#### Sales and Manufacturing

#### *Martin* Sprocket & Gear do Brazil

#### São Paulo, SP

SP 332 Km 154,5  
Artur Nogueira – São Paulo  
CEP 13160-000  
C.P. 138  
Tel: 19 3877 4500

### CHINA

#### Asia Division Headquarters

#### *Martin* Sprocket & Gear (Shanghai) Co., Ltd.

81 Tang Yao Road,  
Hua Ting Town, Jiading District,  
Shanghai 201816, P. R. China  
Tel.: 86-021-67084888  
Fax: 86-021-67084889

#### Changzhou • Fuzhou • Wuhan

#### Zhongshan • Tianjin • Harbin

*Martin* Sprocket & Gear, Inc. • 3100 Sprocket Drive Arlington, TX 76015 • 817-258-3000  
www.martinsprocket.com